

**Affordable Housing for Seniors and People with Disabilities**

Adams Park Apartments offers income-eligible seniors and people with disabilities attractive, well-maintained apartments designed especially to meet their needs. Residents enjoy friendly neighbors along with the following features and amenities:

- Affordable rent includes utilities
- Entrance intercom
- Security cameras in public areas
- Laundry facilities
- Major appliances furnished
- Full-time on-site housing and maintenance staff
- 24-hour emergency maintenance
- Full-time Resident Services Coordinator helps residents access community resources
- Small pets welcome
- Exercise Room
- On-site Food Pantry
- On-site Computer Lab
- Community Room with kitchen
- Recreational opportunities, social and educational events
- City bus stop adjacent



*1440 Fuller Avenue SE, Grand Rapids, MI 49507 | (616) 235-2865*

Conveniently located near shopping and transportation, Adams Park is a 188-unit development that serves people with disabilities and seniors ages 62 and older. Eligible tenants receive a federal rental subsidy, which means rent is not more than 30 percent of the household's adjusted monthly income.

**Adams Park Apartments is currently accepting applications from people with disabilities and seniors age 62 and older.**

Tenants must meet the following income requirements:

Family Size	Maximum Annual Income
One .....	\$53,050
Two .....	\$60,600

Adams Park is operated by the Grand Rapids Housing Commission (GRHC). A Housing Application form for this and other GRHC developments is available online at [www.grhousing.org](http://www.grhousing.org). Prospective tenants can also get an application form and more information by calling the GRHC main office at 616/235-2600.

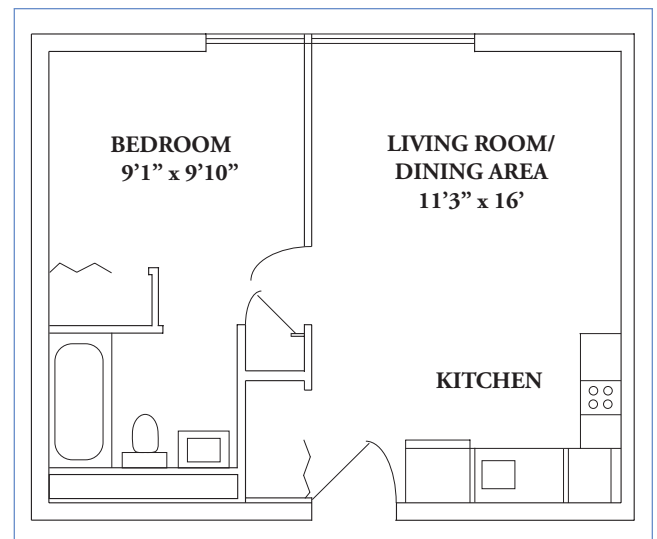

*Floor plan of a typical apartment*

